



# GH <sup>Grade 8</sup> EYE GRAB HOOK



## Grade 8 Eye Grab Hook to EN1677

Product code	Chain dia. mm	WLL tonnes	A mm	K mm	P mm	T mm	Weight kgs / each
G8GH07	7	2	15	60	10	30	0.2
G8GH10	10	3.15	20	84	13	41	0.6
G8GH13	13	5.3	25	102	16	52	1.2
G8GH16	16	8	30	114	20	57	2.3
G8GH19	19	12.5	36	132	23	98	4.6

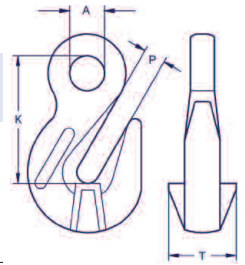

# YA <sup>Grade 8</sup> CONNECTING LINK



## Grade 8 Connecting Link to EN1677

Product code	Chain dia. mm	WLL tonnes	A mm	B mm	D mm	K mm	Weight kgs / each
G8YA07	7	2	20	22	9	57	0.2
G8YA10	10	3.15	26	27	13	68	0.3
G8YA13	13	5.3	30	36	16	91	0.7
G8YA16	16	8	36	39	19	101	1.1
G8YA19	19	12.5	42	44	23	117	1.7

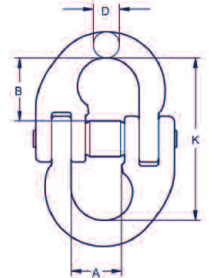

# YR <sup>Grade 8</sup> CLEVIS SHACKLE



## Grade 8 Clevis Shackle to EN1677

Product code	Chain dia. mm	WLL tonnes	G mm	K mm	L mm	W mm	Weight kgs / each
G8YR07	7	2	34	59	35	33	0.4
G8YR10	10	3.15	40	78	48	37	0.8
G8YR13	13	5.3	44	98	64	49	1.3
G8YR16	16	8	54	112	69	60	2.3

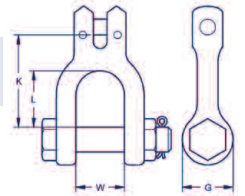

# KK <sup>Grade 8</sup> BARREL HOOK



## Grade 8 Barrel Hook to EN1677

Product code	Chain dia. mm	WLL tonnes	E mm	K mm	W mm	Weight kgs / each
G8KK07	7	2	38	133	50	0.9

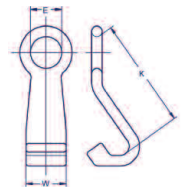

# WS <sup>Grade 8</sup> WEB/ROUND SLING CONNECTOR



## Grade 8 Web/Round Sling Connector to EN1677

Product code	Chain dia. mm	WLL tonnes	A mm	B mm	K mm	W mm	Weight kgs / each
G8WS07	7	2	18	22	62	40	0.3

