

Collared Eyebolt Metric Course Thread to BS 4278/1

British made with machine cut threads; self-colour; tested & certified for lifting; other threads available.

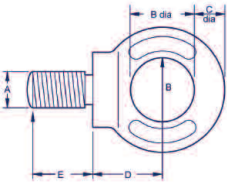

Product code	Vertical Lift WLL tonnes	A mm	B mm	C mm	D mm	E mm	Weight kgs / each
EB1CM006	0.1	6	15	9	20	18	0.06
EB1CM008	0.15	8	15	9	20	18	0.06
EB1CM010	0.25	10	15	9	20	18	0.06
EB1CM012	0.4	12	15	9	20	18	0.06
EB1CM014	0.5	14	20	12	26	23	0.15
EB1CM016	0.8	16	20	12	26	23	0.15
EB1CM018	1	18	24	14	32	28	0.27
EB1CM020	1.6	20	27	16	36	32	0.38
EB1CM022	1.6	22	30	17	40	35	0.54
EB1CM024	2.5	24	35	21	46	40	0.85
EB1CM027	2.5	27	39	23	52	46	1.13
EB1CM030	4	30	44	26	58	51	1.62
EB1CM033	4	33	48	29	64	56	2.37
EB1CM036	6.3	36	54	32	72	63	3.12
EB1CM039	6.3	39	57	33	76	67	3.81
EB1CM042	8	42	68	40	90	79	6.27
EB1CM045	8	45	68	40	90	79	6.45
EB1CM048	10	48	68	40	90	79	6.51
EB1CM052	12.5	52	76	46	102	89	9.58
EB1CM056	16	56	86	51	114	100	12.99
EB1CM064	20	64	96	58	128	112	18.2

Long Shank Collared Eyebolt Metric Course Thread

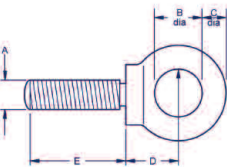

Product code	Vertical Lift WLL tonnes	A mm	B mm	C mm	D mm	E mm	Weight kgs / each
EB2CM010	0.25	10	15	9	20	178	0.18
EB2CM012	0.4	12	19	11	25	178	0.25
EB2CM014	0.5	14	24	14	32	178	0.4
EB2CM016	0.8	16	24	14	32	178	0.44
EB2CM018	1	18	28	17	38	178	0.7
EB2CM020	1.6	20	28	17	38	178	0.7
EB2CM022	1.6	22	38	17	38	178	1.05
EB2CM024	2.5	24	38	22	51	178	1.5
EB2CM030	4	30	48	28	64	178	2.8

Dynamo Eyebolt Metric Course Thread to BS 4278/3

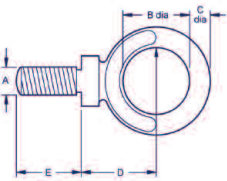

Product code	Vertical Lift WLL tonnes	A mm	B mm	C mm	D mm	E mm	Weight kgs / each
EB3DM006	0.1	6	22	9	27	18	0.07
EB3DM008	0.15	8	22	9	27	18	0.07
EB3DM010	0.25	10	22	9	27	18	0.07
EB3DM012	0.32	12	22	9	27	18	0.07
EB3DM014	0.5	14	32	13	41	28	0.24
EB3DM016	0.63	16	29	11	34	23	0.14
EB3DM018	1	18	40	15	47	32	0.4
EB3DM020	1.25	20	40	15	47	32	0.4
EB3DM022	1.6	22	44	17	53	35	0.61
EB3DM024	2	24	51	19	60	40	0.8
EB3DM030	3.2	30	64	24	76	51	1.72

Long Shank Dynamo Eyebolt Metric Course Thread

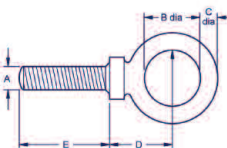

Product code	Vertical Lift WLL tonnes	A mm	B mm	C mm	D mm	E mm	Weight kgs / each
EB4DM008	0.15	8	22	9.5	27	100	0.11
EB4DM010	0.25	10	22	9.5	27	100	0.12
EB4DM012	0.32	12	29	11	35	100	0.17
EB4DM016	0.63	16	32	13	41	114	0.35
EB3DM020	1.25	20	41	16	54	127	0.6
EB3DM024	2	24	51	19	64	127	1.1